

# WElead | SHARI STEIN

When interior designer Shari Stein engaged in pro bono work for the Berkley, Michigan food pantry, Yad Ezra (Hebrew for "helping hands"), she had no idea she was on the path to owning a business! As a volunteer mentor to students from Lawrence Technological University and area high school students, Shari led them in painting murals and producing garden designs for Yad Ezra. The germ of a new business that combined her expertise and commitment to community grew organically alongside Yad Ezra's "Giving Garden." Shari met architect Harold Remlinger during a subsequent pro bono project for Friendship Circle, an organization that fosters friendships between typically developing and developmentally-disabled young people. Shari and Harold discovered they shared the LTU connection (Harold as a teacher there for many years) and shared a similar strong connection to giving back to the community. Their successful collaboration for Friendship Circle ignited the

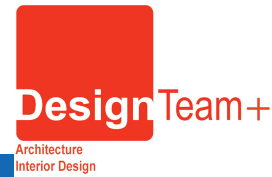

Harold, principal architect and Shari, principle interior designer at Design Team Plus, on a mission for Habitat for Humanity.

formation of their company, DesignTeam Plus (DTP), a full-service architecture and design firm, bringing together their creative abilities and community spirit. Based in Birmingham, Michigan, DTP is celebrating eight years of project ideation and fulfillment in a variety of industries and continues to impact local communities positively and to support non-profits in metropolitan Detroit. "We've withstood COVID-19 by working remotely, thanks to Huntington Technology, who kept our staff connected," Shari said, "Now, with so many people affected, we feel it's more important than ever for us to give back. We understand struggle, we started our business with simply an idea! We want to be a resource for others." DTP's high standard of

service excellence hasn't waned these past months thanks to a strategic approach to the situation. "During COVID-19, we've pivoted how we do business, as others have done. Thanks to a great technology partner and a passionate team for whom we care so much, our work successfully continues." Recent successes include the implementation of a master plan DTP designed for Rochester University in Rochester, Michigan. Lake Norcentra, the center of campus through the years, had grown stagnate. Today, the lake and surrounding green space is a focal point for students and the public and is a great attraction to the city's many bikers along the Clinton River Trail. For Shari's own leadership and mentoring of young professionals, particularly female entrepreneurs, and for her willingness to share passion and excitement with those around her, the Great Lakes Women's Business Council recently awarded Shari the Women's Business Enterprise Michigan Role Model/Mentor of the Year!



"I want to mentor young women who desire to be architects, interior designers and leaders. Being a role model is very important to me," Shari says, "If I can help others to achieve their dreams and live out their passions, I know I've made a difference."